

Soils Map

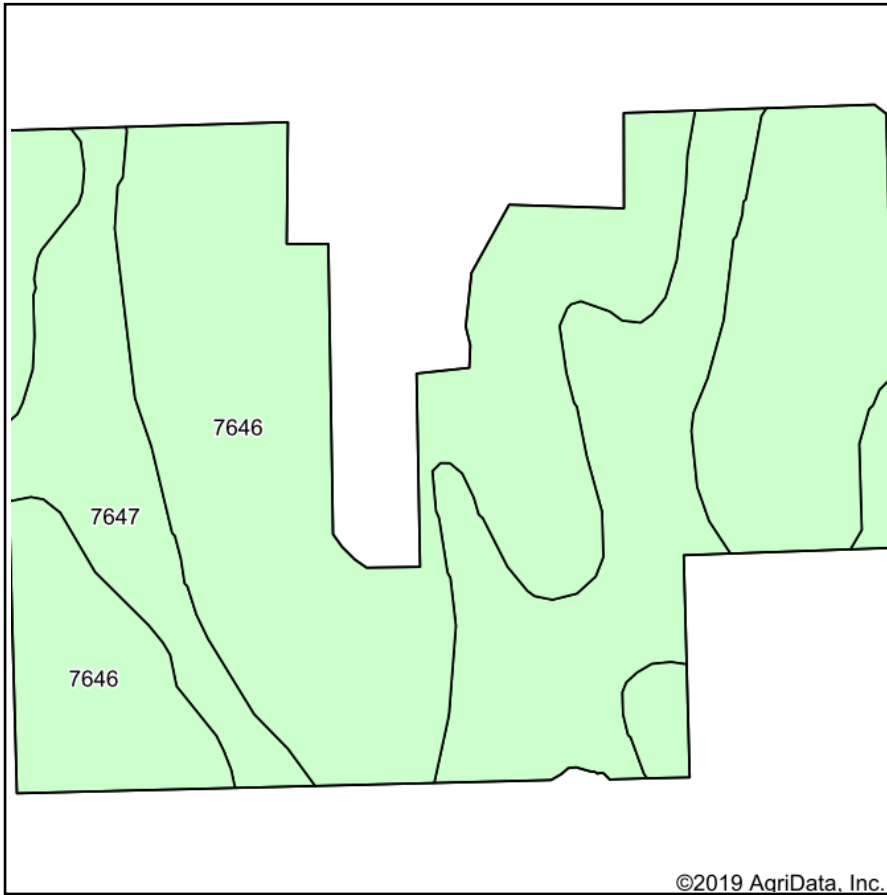

Soils data provided by USDA and NRCS.

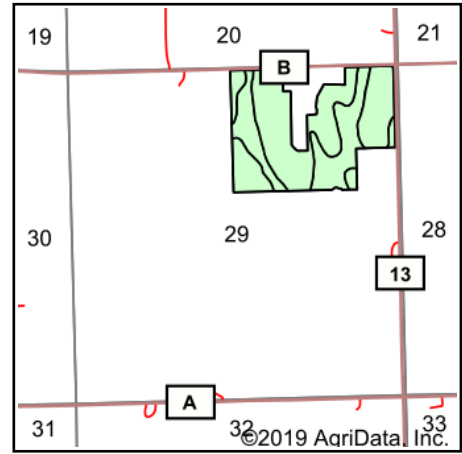

State: **Nebraska**
 County: **Saunders**
 Location: **29-13N-8E**
 Township: **Green**
 Acres: **91.57**
 Date: **1/28/2020**

Maps Provided By:

 CUSTOMIZED ONLINE MAPPING
 © AgriData, Inc. 2019 www.AgriDataInc.com



Area Symbol: NE155, Soil Area Version: 17

Code	Soil Description	Acres	Percent of field	Non-Irr Class *c	Irr Class *c	SRPG	Corn n	Corn Irrigated	Common bermudagrass	Caucasian bluestem	Warm season grasses	Alfalfa hay	Orchardgrass red clover	Tall fescue	Grain sorghum	Soybeans
7646	Yutan, eroded-Judson complex, 6 to 11 percent slopes	62.42	68.2%	IIIe	IVe	71	58	70	1	1	1	2	1	1	51	19
7647	Yutan, eroded-Aksarben silty clay loams, 2 to 6 percent slopes	29.15	31.8%	Ile	IIIe	69	59	72	2	3	3	4	3	2	52	20
Weighted Average						70.4	58.3	70.6	1.3	1.6	1.6	2.6	1.6	1.3	51.3	19.3

*n: The aggregation method is "Weighted Average using major components"

*c: Using Capabilities Class Dominant Condition Aggregation Method

Soils data provided by USDA and NRCS.